

Adjustments

Throttle Control Adjustment (Fig. 1)

Before adjusting carburetor, make sure throttle control is operating properly.

1. Loosen cable clamp screw securing cable to engine.
2. Move remote throttle control lever forward to FAST position.
3. Pull firmly on throttle cable until back of swivel contacts stop.
4. Tighten cable clamp screw.

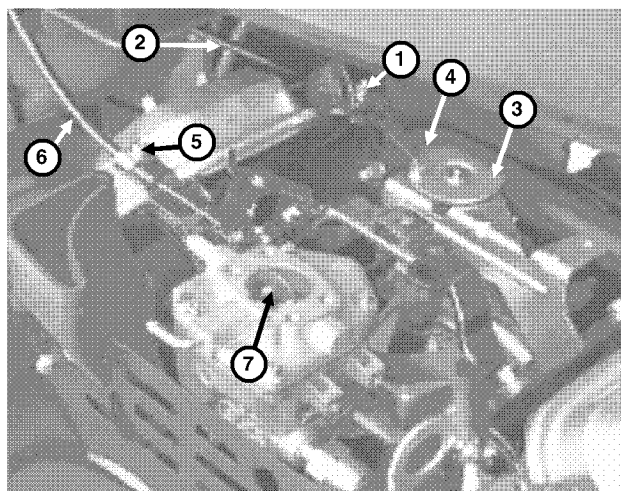

Figure 1

1. Throttle casing clamp screw
2. Throttle cable
3. Swivel
4. Stop
5. Choke casing clamp screw
6. Choke cable
7. Choke butterfly

Choke Control Adjustment (Fig. 1)

1. Loosen cable clamp screw securing cable to engine.
2. Move remote choke control lever forward to CLOSED position.
3. Pull firmly on choke cable until choke butterfly is completely closed, then tighten cable clamp screw.

Governor Adjustment (Before starting engine)

IMPORTANT: If carburetor has been removed or governor linkage disassembled, the governor lever, throttle restrictor and secondary governor spring must be adjusted before the engine is started.

Governor Lever Adjustment (Fig. 2)

All linkage must be installed to make adjustment. Loosen governor lever bolt and nut. Push on governor lever until throttle is wide open. **DO NOT** bend governor link. Hold lever in this position and rotate governor shaft counterclockwise as far as it will go. Hold lever and shaft in position and torque governor lever bolt and nut to 70 in-lb.

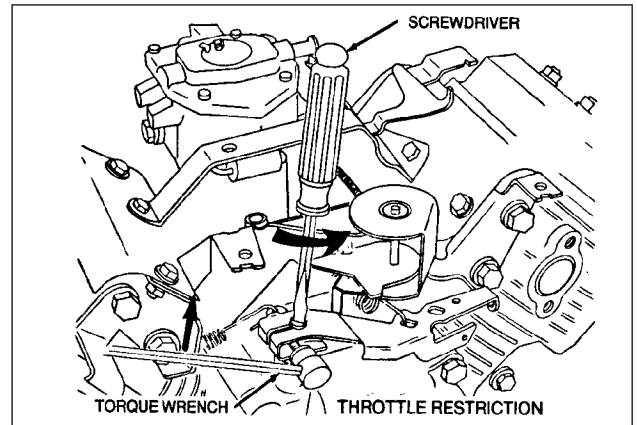

Figure 2

Throttle Restrictor Adjustment (Fig. 3)

Move throttle control lever to SLOW position. Hold governor lever so that throttle lever touches idle speed adjustment screw. Use tang bender (Briggs & Stratton Tool #19352) and bend throttle restrictor tang so throttle opening is limited to 1/4 in. travel when governor lever is released.

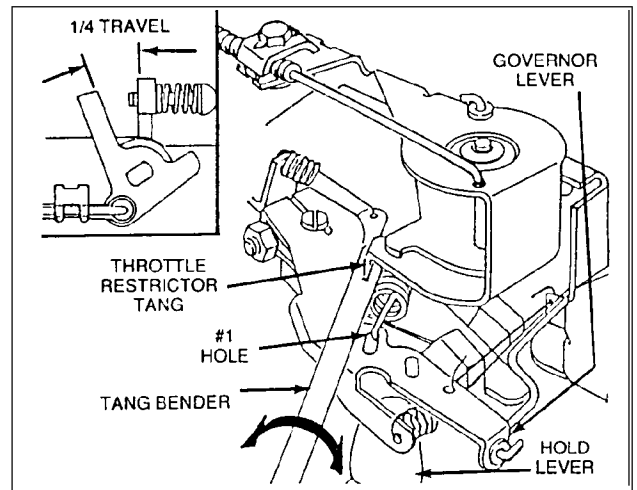

Figure 3

Secondary Spring Adjustments (Fig. 4)

With throttle control lever in SLOW position, install adjustment gauge (Briggs & Stratton Tool #19385) over end of governor lever as shown. Holding gauge in position, bend tab so that all slack is removed from secondary governor spring between its two anchor points. **DO NOT STRETCH SPRING.** Remove adjustment gauge.

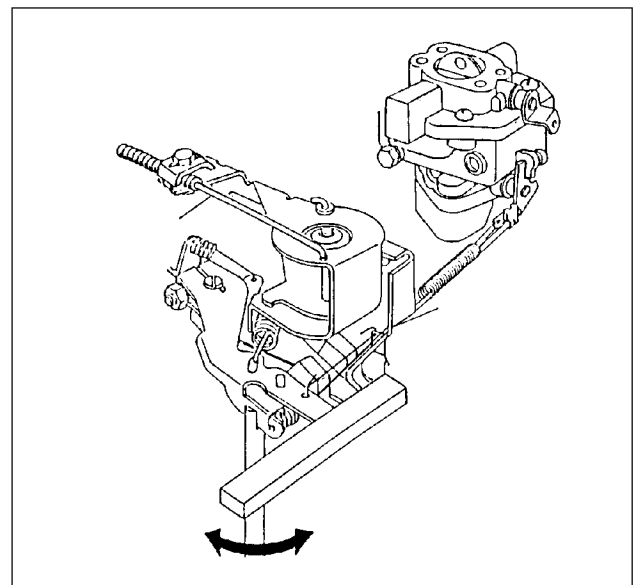

Figure 4

Carburetor and Speed Control Adjustment (Fig. 5, 6)

IMPORTANT: Before carburetor and speed control are adjusted, the throttle and choke controls must be adjusted properly.



WARNING

Engine must be running during adjustment of carburetor and speed control. To guard against possible personal injury, shift into neutral and engage parking brake. Keep hands, feet, face and other parts of the body away from the cutter blades and any rotating engine parts.

1. Start engine and let it run at half throttle for approximately five (5) minutes to warm up.

2. Move throttle control to SLOW position. Hold governor lever so throttle lever is in the idle position (against idle stop screw) and turn idle stop screw in or out to get 1400 ± 50 RPM. Check speed with a tachometer.

3. Adjust idle mixture screw:

A. Turn idle mixture screw slowly clockwise (lean mixture) until engine speed just starts to decrease. Note position of screw.

B. Now turn idle mixture screw slowly counterclockwise (rich mixture) until engine speed just starts to decrease. Note position of screw.

C. Set the idle mixture screw half way between the rich and lean settings.

4. After idle mixture has been adjusted, hold governor lever so throttle lever is in idle position (against idle stop screw) and adjust idle stop screw to bring engine speed to $1200 \pm$ RPM.

5. With governor control lever in governed idle position (no tension on high speed spring) bend governed idle spring anchor tang to get a governed idle speed of $1400 \pm$ RPM (Fig. 5).

6. Move throttle control to FAST position. Bend high speed spring anchor tang to bring engine speed to $2800 +50/-100$ RPM (Fig. 6).

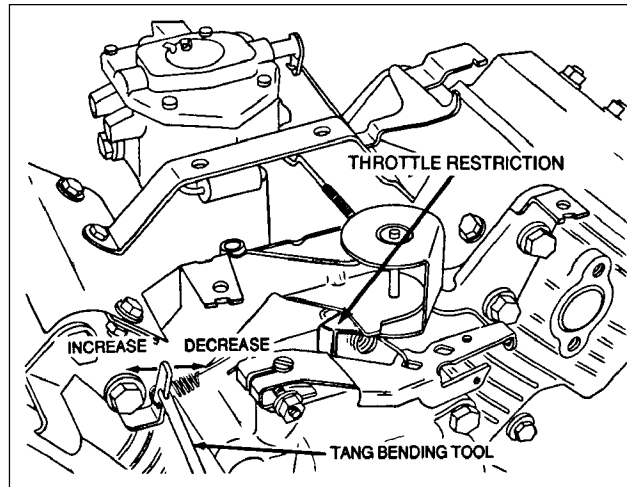

Figure 5

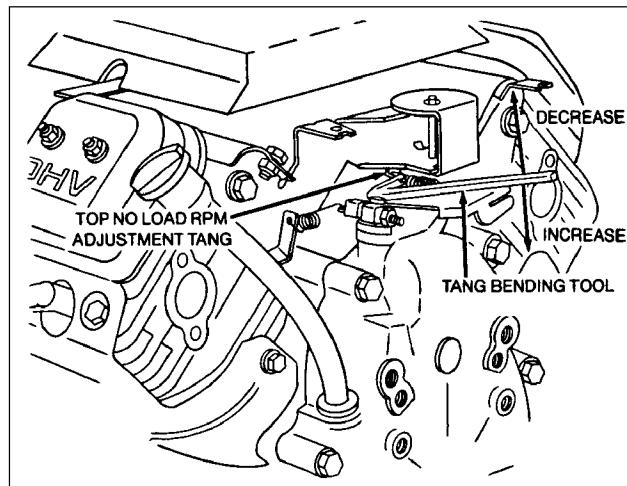

Figure 6